

PM

Radial piston pumps

Size 2 (Solid concept)
 500 Bar - 700 Bar
 0,565 to 12,06 cm³/rev

Applications:

- Cutting device
- Offshore applications
- Synchronisation units (multiple P-port connections)
- Lifting systems
- Presses

Design:

- High-strength aluminum body and piston-cover
- Modular concept (easy to replace piston assembly)
- Customized assembly possible
- Marine version = FPM seals + special coated external parts

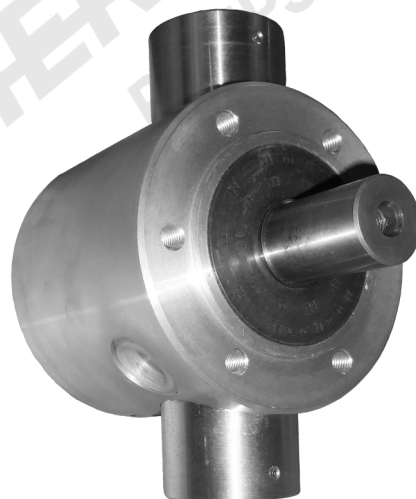

Features:

- Light weight solid version
- High volumetric efficiency (up to 98%)
- Wide speed range (100 > 3000 rev/min)
- Inexpensive design
- 1 to 6 Pressure outputs possible (depending on n° pistons)
- Low pulsation, low noise level
- Self-priming and venting
- Offshore versions available (Marine version)

Technical data:

| | |
|------------------------------------|---|
| Hydraulic fluid | Mineral or synthetic oil according DIN 51524 (BIO, other on demand) |
| Viscosity range | 10 to 220 mm ² /s |
| Recommended oil | ISO VG 10 to 68 cSt (conf. DIN 51 519) |
| Filtration | According ISO/DIN 4406 17/15/12 (NAS 1638 class 6) |
| Fluid temperature range | -30 to +80°C (attention to the viscosity range) |
| Ambient temperature range | -40 to +60°C |
| Speed range | 100 to 3000 rev/min |
| Direction of rotation | Bi-directional |
| Suction height | max 500mm |
| Operation pressure on suction port | -0,2 Bar to 0,5 Bar |
| Max pressure on output port | 500 Bar or 700 Bar (depending on piston size and version) |
| Axial force on driving shaft | Not allowed |
| Radial force on driving shaft | On request |
| Port connections | Via fittings ISO 228/1 (BSP), other on demand) |

Size 2 (Solid concept)
 500 Bar - 700 Bar
 0,565 to 12,06 cm³/rev



Ordering Code:

| (Example) | PM | /04 | -700 | 4x1,13 | - | -M | -Sxxx |
|--|----|-----|------|--------|---|----|-------|
| Radial piston pump Size 2 - (Closed body, no extension) | ↑ | ↑ | ↑ | ↑ | ↑ | ↑ | ↑ |
| Number of pistons (see table) | | ↑ | | | | | |
| Max Pressure - 500 Bar or 700 Bar | | | ↑ | | | | |
| Displacement (cm ³ /rev) (4xP-port, see table) | | | | ↑ | | | |
| Connection for second pump - (not available) | | | | | ↑ | | |
| Seal version (Omit = NBR) - F = FPM (Viton), M (Marine Version) | | | | | | ↑ | |
| Special version | | | | | | | ↑ |

(More P-port connections on request)

Maximum pressures and displacements of the standard program:

| Size | Housing | Nb of Pis- tons | Pressure (bar) / displacement (cm ³) by piston diameter | | | | | |
|------|---------|--------------------|---|----------|----------|----------|----------|-----------|
| | | | ∅ 6 mm | ∅ 8 mm | ∅ 9 mm | ∅ 10 mm | ∅ 12 mm | ∅ 16 mm |
| 2 | PM | 2 | 700/0,565 | 700/1,05 | 700/1,28 | 700/1,58 | 700/2,26 | 500/4,02 |
| | | 3 | 700/0,847 | 700/1,57 | 700/1,92 | 700/2,37 | 700/3,39 | 500/6,03 |
| | | 4 | 700/1,13 | 700/2,10 | 700/2,54 | 700/3,14 | 700/4,52 | 500/8,04 |
| | | 6 | 700/1,70 | 700/3,02 | 700/3,82 | 700/4,71 | 700/6,79 | 500/12,06 |



HYDROSERV - Wimmerpumps

Ninovesteenweg 212 F - B 9320 Erembodegem

Tel: +32 (0)53 71 12 12

Email : contact@wimmerpumps.com

info@hydroserv.eu